

Andersen Library Main Collection Book Stack Directory

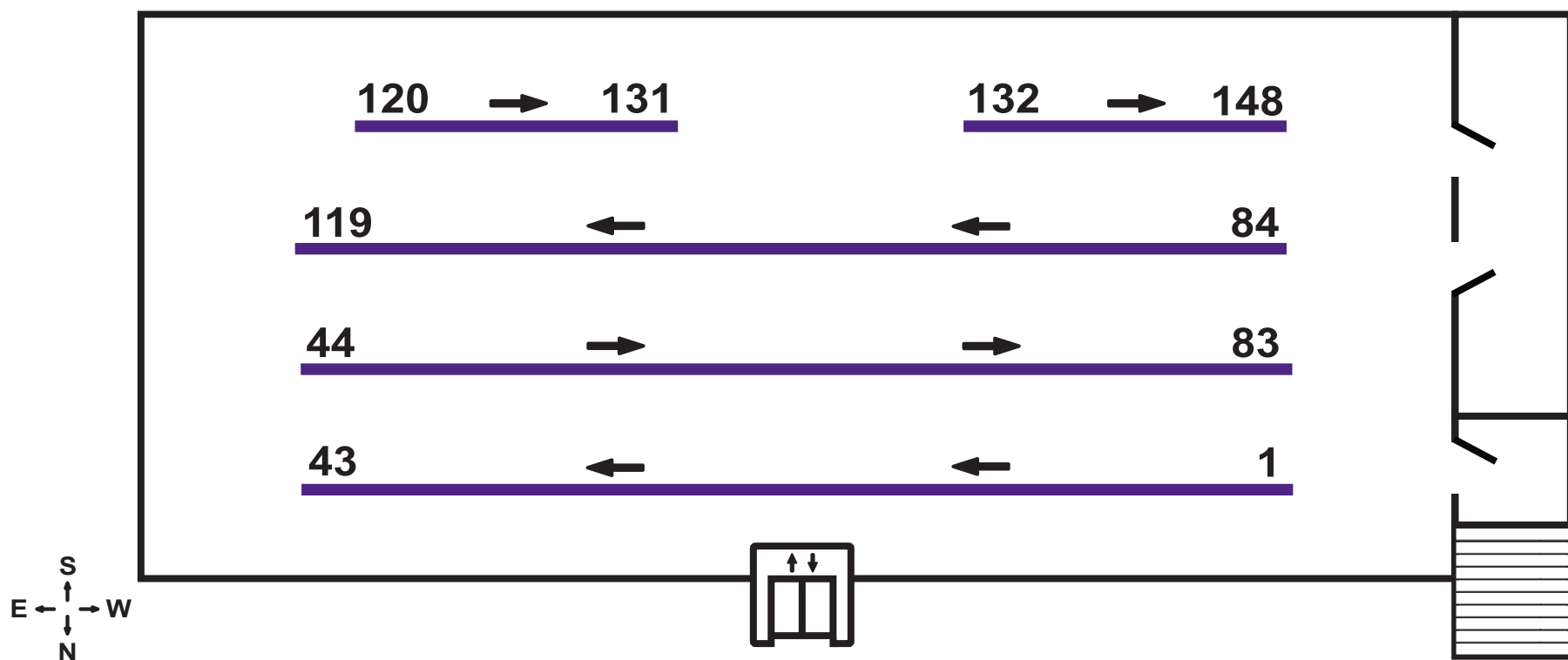

Main Collection

| | |
|-------------------|------------------------------|
| A - B 819 | 1 |
| B 819 - BD 111 | 2 |
| BD 111 - BF 204 | 3 |
| BF 204 - BF 575 | 4 |
| BF 575 - BF 724 | 5 |
| BF 723 - BL 51 | 6 |
| BL 51 - BP 130 | 7 |
| BP 130 - BS 1237 | 8 |
| BS 1243 - BX 1750 | 9 |
| BX 1750 - CB 358 | 10 |
| CB 358 - D 385 | 11 |
| D 387 - D 839 | 12 |
| D 840 - DA 462 | 13 |
| DA 462 - DC 123 | 14 |
| DC 123 - DE 15 | 15 |
| DE 29 - DK 266 | 16 |
| DK 266 - DS 112 | 17 |
| DS 112 - DS 557 | 18 |
| DS 557 - DT 15 | 19 |
| DT 15 - DU 740 | 20 |
| DU 740 - E 157 | 21 |
| E 158 - E 183 | 22 |
| E 183 - E 185 | 23 |
| E 185 - E 302 | *ongoing shifting project 24 |
| E 302 - E 469 | *ongoing shifting project 25 |
| E 469 - E 768 | *ongoing shifting project 26 |
| E 769 - F 129 | *ongoing shifting project 27 |
| F 129 - F 592 | *ongoing shifting project 28 |
| F 592 - F 1215 | *ongoing shifting project 29 |
| F 1215 - F 3442 | *ongoing shifting project 30 |
| F 3442 - GN 345 | *ongoing shifting project 31 |
| GN 345 - GV 350 | *ongoing shifting project 32 |
| GV 351 - GV 1057 | *ongoing shifting project 33 |
| GV 1058 - HA 31 | *ongoing shifting project 34 |
| HA 31 - HB 849 | *ongoing shifting project 35 |
| HB 850 - HC 106 | *ongoing shifting project 36 |
| HC 106 - HC 336 | *ongoing shifting project 37 |
| HC 336 - HD 31 | *ongoing shifting project 38 |
| HD 31 - HD 62 | *ongoing shifting project 39 |
| HD 62 - HD 199 | *ongoing shifting project 40 |
| HD 200 - HD 5726 | *ongoing shifting project 41 |
| HD 5726 - HD 8039 | *ongoing shifting project 42 |
| HD 8039 - HD 9719 | *ongoing shifting project 43 |
| HD 9720 - HF 1411 | 44 |
| HF 1411 - HF 5415 | 45 |
| HF 5415 - HF 5548 | 46 |
| HF 5548 - HF 5661 | 47 |
| HF 5561 - HG 186 | 48 |
| HG 187 - HG 4916 | 49 |
| HG 4921 - HM 131 | 50 |

| | |
|-------------------|-----|
| HM 131 - HN 57 | 51 |
| HN 57 - HQ 76 | 52 |
| HQ 76 - HQ 784 | 53 |
| HQ 784 - HQ 1413 | 54 |
| HQ 1413 - HV 40 | 55 |
| HV 40 - HV 4505 | 56 |
| HV 4505 - HV 6789 | 57 |
| HV 6789 - HX 529 | 58 |
| HX 530 - JF 1351 | 59 |
| JF 1351 - JL 950 | 60 |
| JL 951 - JX 231 | 61 |
| JX 231 - K 375 | 62 |
| K 376 - KF 1449 | 63 |
| KF 1450 - KF 7650 | 64 |
| KF 7651 - LA 206 | 65 |
| LA 206 - LB 875 | 66 |
| LB 875 - LB 1050 | 67 |
| LB 1050 - LB 1576 | 68 |
| LB 1576 - LB 2823 | 69 |
| LB 2823 - LC 1011 | 70 |
| LC 1011 - LC 6691 | 71 |
| LD 13 - M 1620 | 72 |
| M 1620 - ML 410 | 73 |
| ML 410 - ML 1099 | 74 |
| ML 1100 - MT 948 | 75 |
| MT 948 - N 6999 | 76 |
| N 7000 - NC 139 | 77 |
| NC 140 - ND 553 | 78 |
| ND 553 - NK 4210 | 79 |
| NK 4210 - P 121 | 80 |
| P 121 - PC 4111 | 81 |
| PC 4111 - PG 3467 | 82 |
| PG 3467 - PN 56 | 83 |
| PN 56 - PN 1730 | 84 |
| PN 1731 - PN 2266 | 85 |
| PN 2266 - PN 4781 | 86 |
| PN 4781 - PN 6725 | 87 |
| PN 6725 - PQ 2613 | 88 |
| PQ 2613 - PQ 6410 | 89 |
| PQ 6410 - PR 421 | 90 |
| PR 421 - PR 1175 | 91 |
| PR 1175 - PR 2831 | 92 |
| PR 2832 - PR 3588 | 93 |
| PR 3588 - PR 4711 | 94 |
| PR 4711 - PR 5906 | 95 |
| PR 5906 - PR 6045 | 96 |
| PR 6045 - PS 151 | 96 |
| PS 151 - PS 628 | 98 |
| PS 628 - PS 2162 | 99 |
| PS 2162 - PS 3511 | 100 |

| | |
|-------------------|-----|
| PS 3511 - PS 3537 | 101 |
| PS 3537 - PS 3556 | 102 |
| PS 3556 - PS 3569 | 103 |
| PS 3569 - PT 2613 | 104 |
| PT 2613 - PZ 71 | 105 |
| Q1 - QA 76 | 106 |
| QA 76 - QA 276 | 107 |
| QA 276 - QA 614 | 108 |
| QA 614 - QC 407 | 109 |
| QC 407 - QD 275 | 110 |
| QD 276 - QH 104 | 111 |
| QH 104 - QK 1 | 112 |
| QK 2 - QL 661 | 113 |
| QL 662 - QP 301 | 114 |
| QP 301 - R 154 | 115 |
| R 154 - RC 117 | 116 |
| RC 118 - RC 488 | 117 |
| RC 488 - RD 96 | 118 |
| RD 97 - RM 315 | 119 |
| RM 315 - SB 945 | 120 |
| SB 950 - T 57 | 121 |
| T 57 - TD 196 | 122 |
| TD 201 - TK 5105 | 123 |
| TK 5105 - TL 720 | 124 |
| TL 720 - TR 680 | 125 |
| TR 681 - TX 360 | 126 |
| TX 361 - UA 23 | 127 |
| UA 23 - VK 230 | 128 |
| VK 231 - Z 689 | 129 |
| Z 689 - Z 5776 | 130 |
| Z 5777 - ZA 4450 | 131 |

Oversize

| | |
|--------------|-----|
| A - DQ | 132 |
| DR - E 663 | 133 |
| E 664 - GN | 134 |
| GR - HD | 135 |
| HD - HF 5685 | 136 |
| HF 5686 - KD | 137 |
| KD - LT | 138 |
| M1 - M 1500 | 139 |
| M 1500 - N | 140 |
| N - NC | 141 |
| ND - NK | 142 |
| NK - PR | 143 |
| PR - QC | 144 |
| QC - QL | 145 |
| QL - SB | 146 |
| SB - TR | 147 |
| TR - END | 148 |